

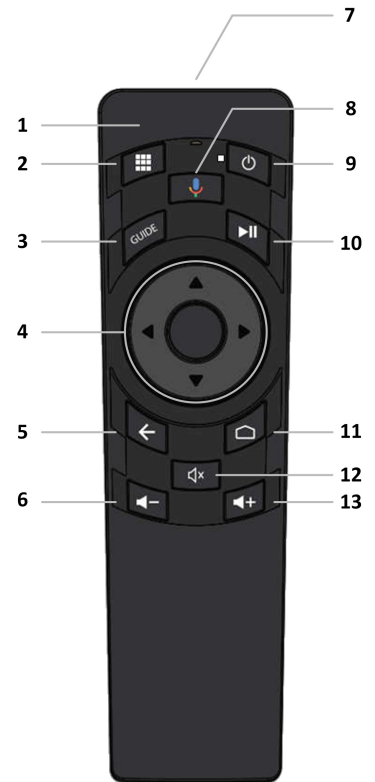

1. Remote control layout

- 1 Indicator LED
- 2 Menu
- 3 Electronic Program Guide
- 4 Navigation and OK
- 5 Back
- 6 Volume down
- 7 Infra-red (IR) window
- 8 Voice control
- 9 Power/standby
- 10 Play/pause
- 11 Home
- 12 Mute
- 13 Volume up



Note: Some functionality may not be available on specific models of set-top box, and availability of certain features is dependent on your service provider.

2. Inserting batteries

- 1 Slide the battery housing cover downwards to remove.
- 2 Insert 2 x AAA batteries observing the correct polarity.
- 3 Refit the battery housing cover.

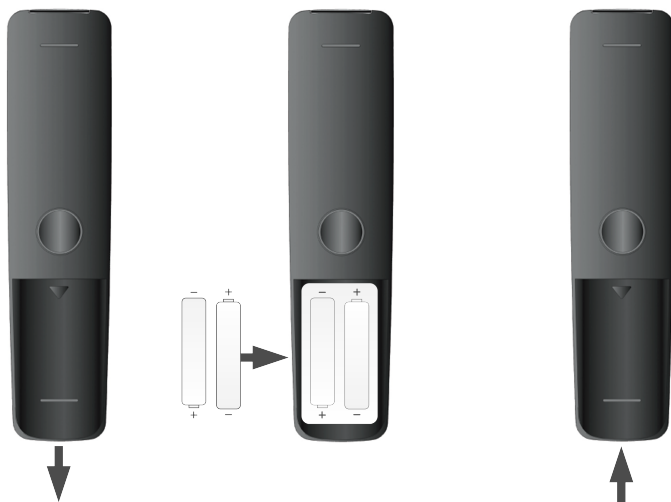

Battery information

Do not mix different types of battery or old and new batteries and do not use rechargeable batteries with the remote control.

Remove the batteries from the remote control if you are not going to use it for several weeks, to avoid the risk of leakage.

Please respect your environment and any local regulations and dispose of old batteries in a responsible manner.

Do not attempt to recharge the batteries.

Immediately remove any leaking batteries. Take care when handling leaking batteries as they may cause burns to your skin or eyes, or other physical injuries.

3. Operation

When you press a key, point the remote control towards the front of the set-top box (STB) to ensure correct operation. Do not cover the infra-red (IR) window at the front of the remote control and at the front of the STB.

When you press a key, the LED will flash. If you press a key for more than 30 seconds the remote control will stop transmitting commands to preserve battery life.

4. Setting the Power and Volume keys

The Mini ATV remote control can operate in two modes: either as infra red (IR) or Bluetooth (RF). Your TV can receive IR signals and your STB can receive IR and RF, depending on the model. All the setup features for your STB can be controlled in either mode.

The Power/Standby and Volume keys (VOL+, VOL-, Mute) can be set as 'TV keys' or 'STB keys' depending on whether you want them to control the TV or the STB.

To set these keys as 'TV keys' to control the TV, press **MENU** and **LEFT** simultaneously for three seconds until the LED flashes once to confirm.

To set these keys as 'STB keys' to control the STB, press **MENU** and **RIGHT** simultaneously for three seconds until the LED flashes once to confirm.

5. Setting the STB control mode

The STB can be controlled either by IR or RF.

To set the control mode to IR, press **MENU** and **UP** simultaneously for three seconds until the LED flashes once to confirm.

You can only set the control mode to RF if the remote has been paired to the STB (see below). If the remote control is paired, set the control mode to RF by pressing **MENU** and **DOWN** simultaneously for three seconds until the LED flashes once to confirm.

6. Pairing the remote control to the STB

The remote control must be paired with an STB to control it. Pairing can be automatic or manual. A remote control can only pair with one STB at a time.

Auto pairing

This will be triggered by the remote control in the following cases:

- for 60 seconds after the batteries have been inserted
- or
- if it has had all data cleared (see clearing pairing) or has been reset to factory ults (see factory reset).
- or
- after any key is pressed and the LED flashes to confirm the key press (this restarts the 60-second timeout).

If pairing does not occur after 60 seconds, pressing any key will restart the auto pairing process.

Note: If the remote control already contains pairing information (for example, if you have previously paired it to an STB), you must manually pair it with the STB.

Manual pairing

For pairing, the STB must be in pairing mode, which is:

- for two minutes after the STB boots up
- or
- when there are remote control pairing instructions shown on screen (depending on the STB firmware version)

1. Press **MENU** and **OK** simultaneously for at least three seconds until the LED flashes twice to acknowledge the key press. The timeout for pairing is 60 seconds.



2. If pairing is successful:

The LED flashes once to confirm pairing and the remote control changes to Bluetooth (RF) mode. The STB may indicate this change of mode depending on the middleware or firmware version.

3. If pairing is unsuccessful:

The LED gives a long flash to indicate an error and the remote control remains in its current mode.

Clearing pairing

To clear the pairing data, press **Menu** and **Home** simultaneously for three seconds until the LED flashes twice and remains on. After clearing, the LED flashes once and the remote control returns to user mode.

7. Learning mode

The Mini ATV remote control can learn a key function from another 'source' remote control.

Choose your 'target key' on the Mini ATV remote control. It must be one of the following keys: Power, VOL+, VOL-, MUTE. The target key will learn a function from the source remote control.

1. Press **Back** and **Home** simultaneously for three seconds until the LED flashes twice and remains on. The Mini ATV remote control is now in learning mode.
2. Hold the Mini ATV remote control 3 - 6 cm from the source remote control with the IR windows facing each other. On the **source remote control** press the key to be learned (e.g. if your target key on the Mini ATV remote control is **mute**, press **mute** on the source remote control).
3. If learning is successful, the LED will flash and the Mini ATV remote control will return to user mode.
4. If learning is unsuccessful, the LED will give a long error flash and return to user mode.
5. To clear the target key, press **Back** and **Home** simultaneously for three seconds. The LED will flash twice and remain on. On the Mini ATV remote control press your **<target key>** twice. The LED will give a confirmation flash and the learning data is cleared.

8. TV reset

1. Press **Menu** and **Back** simultaneously for at least three seconds until the LED flashes twice and remains on.

2. After the remote control has erased its settings it returns to IR mode. The LED will flash once and the remote control returns to user mode. y

9. Factory reset

1. Press **Menu** and **Guide** simultaneously for at least three seconds until the LED flashes twice and remains on.

2. After the remote control has erased its settings the LED will flash once. The remote control will now return to factory settings: Bluetooth (RF) mode, no learning data and unpaired.

Setup features key combinations

< > normal key-press

<< >> hold for three seconds

Set STB control medium to IR	<< Menu + Up >>
Set STB control medium to RF	<< Menu + Down >>
Set Power key and Volume Keys as TV keys	<< Menu + Left >>
Set Power key and Volume Keys as STB keys	<< Menu + Right >>
IR Learning	<< Back + Home >>, < learn key >
Clear Learning Data	<< Back + Home >>, < learn key >, < learn key >
Reset TV configuration	<< Menu + Back >>
Clear Pairing Table	<< Menu + Home >>
Factory Reset	<< Menu + Guide>>