



Stylus Remote Control User Guide



4. TV control setup: Brand Search

The remote control can be programmed to operate certain functions of your TV set. To do this, follow the instructions below.

1. Note the brand of your TV set.
2. Note the 4-digit brand code for your TV set by referring to the brand code tables on the Amino support site (www.aminocom.com/support).
3. Make sure your TV set is turned on. The STB does not need to be turned on to perform this programming feature.
4. On the remote control, press and hold the **SETUP** button (1) until the remote control LED blinks twice, then release the **SETUP** button.
5. Enter the 4 digit brand code for your TV set. If you perform this procedure correctly, the remote control LED will blink twice. Otherwise, it will give a long blink.
6. Press the **TV** button (2). If the TV turns off, setup is complete.
7. If the TV does not turn off, repeat this procedure with the next brand code.

5. TV control setup: Auto Search

If the TV brand cannot be found by the previous Brand Search method then Auto Search can be used. Note: this process may take several minutes to find your TV code.

1. Make sure your TV set is turned on. The STB does not need to be turned on to perform this programming feature.
2. On the remote control, press and hold the **SETUP** button until the remote control LED blinks twice, then release the **SETUP** button.
3. Enter **991** using the number buttons.
4. Press the **CH +** button (16) repeatedly until the TV turns off.
5. Press and hold the **SETUP** button until the remote control LED blinks twice to save the working code.

1. Operation

When the remote control is first operated all buttons transmit commands for the set-top box (STB). The exact button function will depend on your service provider. When pressing a remote control button point the remote control towards the front of the STB to ensure correct operation. Do not cover the infra-red (IR) window at the front of the STB.

When a button on the remote control is pressed, either the STB standby button or the TV standby button (if a TV brand has been entered) will flash, depending on which product is being controlled by the remote control.

If a button is pressed for more than 30 seconds the remote control will stop transmitting commands to preserve battery life.

2. Remote control layout

- 1 LED indicator
- 2 TV power on/off
- 3 Menu button
- 4 Back button
- 5 Colour navigation buttons
- 6 Volume up and down buttons
- 7 Mute button
- 8 Input button for entering a full stop (period) or for displaying the on-screen keyboard
- 9 Set up button
- 10 STB power on or standby
- 11 Information button
- 12 Navigation and OK buttons
- 13 Exit button
- 14 STB PVR transport buttons
- 15 Electronic Program Guide (EPG) button
- 16 Channel up and down buttons or Page up and down buttons for EPG
- 17 Channel select buttons and text entry
- 18 OPT TEXT button for additional options within menus and for toggling teletext on/off

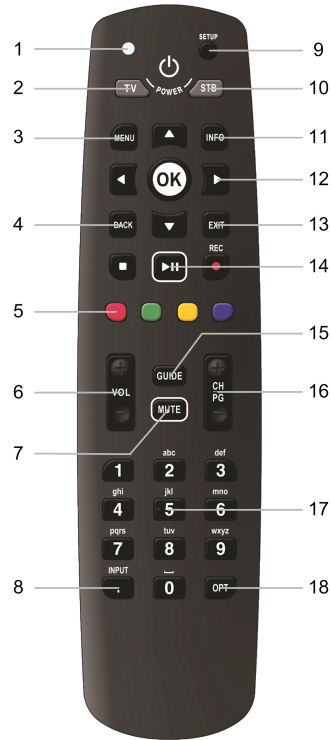

Note: Some button functionality (e.g. PVR) may not be available on specific models of STB, and availability of certain features is dependent on your service provider.

3. Inserting batteries

1. Press the indent on the battery housing cover and slide it downwards to remove.
2. Insert 2 x AAA batteries, observing the correct polarity.
3. Refit the battery housing cover.

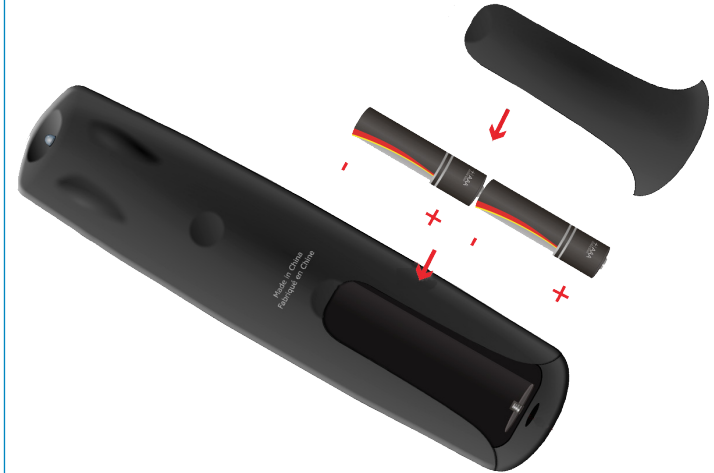

Battery information

Do not mix different types of battery or old and new batteries.

Do not use rechargeable batteries with the remote control. Do not attempt to recharge the batteries.

Remove the batteries from the remote control if you are not going to use it for several weeks, to avoid the risk of leakage.

Immediately remove any leaking batteries. Take care when handling leaking batteries as they may cause burns to the skin or eyes, or other physical injuries.

Please respect your environment and any local regulations and dispose of old batteries in a responsible manner.